

# MAC Garbage Converter Vessel

DP2, FiFi 1, Oil Recovery

## MARINE ASSETS CORPORATION

SHIP BUILDERS, OWNERS AND OPERATORS

#3606 Jumeirah Bay X3, X-Cluster,

Jumeirah Lake Towers (JLT) Dubai

Email: info@macoffshore.net



### PRINCIPAL PARTICULARS

Year Built	2015
Builder	Fujian Mawei Shipyard
Call Sign	TBA
Official No.	TBA
Class	ABS +A1 E Offshore Support Vessel, FFV1 AMS, DPS 2, SPS, OSR-C1
Flag	TBC

### DIMENSIONS

Length Overall	59.60m
Length BP	56.90 m
Beam Molded	15.20m
Depth moulded	6.20m
Design Draft	4.80m

### MACHINERY

Main Engines	2 x 1200BHP
Propellers	2 x 1200HP 360 deg Azimuths CPP
Bow Thrusters	2 x 450 Kw tunnel Thrusters
Generators	4 x 500 kw/3 ph/415 V/60Hz

Emergency Generator 1 x 95 kw/3 ph/415 V/60Hz

### SPEED

Speed	12. Knots @ 100% MCR
Type of Fuel	Marine Diesel Oil
Fuel Consumption	TBA

### CAPACITIES

Fuel Oil	520 m <sup>3</sup>
Fresh Water	370 m <sup>3</sup>
Water Ballast/Drill Water	500 m <sup>3</sup>
Recovered Oil	180 m <sup>3</sup> (Optional)

Deadweight	Approx 1200T at design draft
Deck Cargo Capacity	TBA
Cargo Deck Free Area	420 m <sup>2</sup>
Deck Strength	7t/ m <sup>2</sup>
Freezer	To store provisions for a period of 30 Days
Cooler	To store provisions for a period of 30 Days

### PUMPS

Fuel	1 x 150 m <sup>3</sup> /hr @ 80m hd
Fresh Water/Drill Water	2 x 100 m <sup>3</sup> /hr @ 80m hd
Garbage Convertors	3 x NV1000
Oil Recovery	Optional

### ACCOMMODATION

One Man Cabins	2
Two Man Cabin	4
Four men cabins	10
Total	<b>50 men</b>
1 x Hospital	1 beds
Offices	Optional
Gym	Optional
Fully Air Conditioned.	HVAC Integrated with F&G system
Fixed gas Detection	H2s and LEL

### AUXILIARY EQUIPMENT

1 x 5 t/d RO Fresh Water Maker  
Oily Bilge Water Separator  
2 x Ships Air Compressor 24m<sup>3</sup>/hr  
Sewage treatment plant suitable for 50 men

### RADIO & NAVIGATION EQUIPMENT

GMDSS: Area 3  
1 x Inmarsat C and F  
1 x MF/HF-DSC Radio Telephone  
2 x VHF-DSC Radio Telephone  
3 x VHF Portable radios  
1 x Navtex Receiver,  
1 x EPIRB, 2 x SART  
1 x Auto Telephone system  
1 x Sound Powered Telephone system  
1 x PA/Talkback System  
1 x TV and Radio system  
1 x Magnetic Compass  
1 x Gyrocompass  
1 x DGPS  
1 x Autopilot  
2 x day light display radars. One with Automatic Electronic Plotting Facility  
1 x Echo Sounder 1x Speed log 3 x2000w Search lights  
1 x Anemometer 1 x Barometer, 4 x Clinometer, 1 x Chronometer  
1 x Weather Fax Receiver  
1 x daylight signaling light  
Local Area Network (LAN) connected  
AIS

**DP MT** C Pos DPS-2, with following reference systems:

2 x Gyro Compass - 3 x Joystick, 2 x DGPS, 1 x Radius

### DECK & AUX. EQUIPMENT

Anchors	2 x 1440kgs HHP
Chain	34mm U2 grade Tot 440 M
Anchor/ Mooring Windlass	1 x 5t @ 12m/min C/W warping heads
Tugger Winches	2 x 10t @ 12m/min
Capstans	2 x 5t @ 15m/min
Deck crane (Optional)	18 @ 12M (OFE)

### FIRE FIGHTING & LSA EQUIPMENT

External FiFi	Class 1
Pump	2 x 1700 m <sup>3</sup> /hr @ 125 m hd
Monitors	2 x 1200 m <sup>3</sup> /hr @ 12 bar with remote control
Dispersant spray boom	2 x 25 m <sup>3</sup> /hr @ 30 m hd
Water Spray curtain round the hull and wheel house	

### Fire Extinguishing System

Engine Room CO2 Sstem  
12 x Fire hydrants and fire extinguishers as per Class requirements  
4 x fireman outfits  
4 x fire blankets for Engine room and galley

### Life Saving Equipments

6 x 25 man life rafts SOLAS approved (3 each side)  
8 x Lifebuoys SOLAS approved  
58 Lifejackets as per SOLAS requirement  
1 x Line Throwing Apparatus  
12 x Parachute Distress Signals  
2 x Orange Smoke Signals  
SOLAS approved line throwing appliance  
1 x First Aid Kit  
1 x 15 men diesel powered FRC with davit for Launch/Recovery.  
2 x Fire Blankets

**PRINCIPAL DIMENSIONS**

- LENGTH OVERALL 59.60 m
  - BREADTH BP ~57.4 m
  - BREADTH MOULDED 15.20 m
  - DEPTH MOULDED 6.20 m
  - DESIGN DRAFT MOULDED 4.80 m
  - FUEL OIL 520 m<sup>3</sup>
  - FRESH WATER 370 m<sup>3</sup>
  - BALLAST WATER/DRILL WATER 500 m<sup>3</sup>
  - ACCOMMODATION 41 men
  - SPECIAL PERSONNEL 11 men
  - CLEAR DECK AREA (DECK LOADING 7 t/m<sup>2</sup>) 400 m<sup>2</sup>
  - DECK CARGO 600 tonnes
  - TOTAL POWER 2x1200 kW
  - SPEED (4.8m Draft) 12.0 kn
- CLASS & NOTATION : ABS #A1@ OFFSHORE SUPPORT VESSEL,  
SPS, + AMS+DPS-2

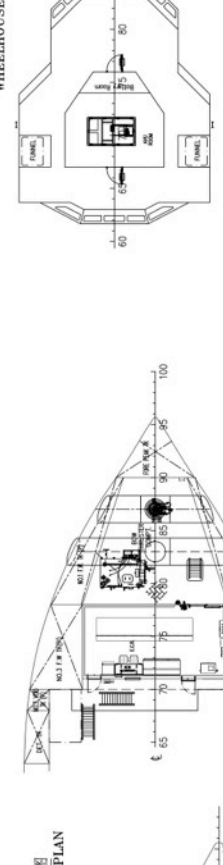
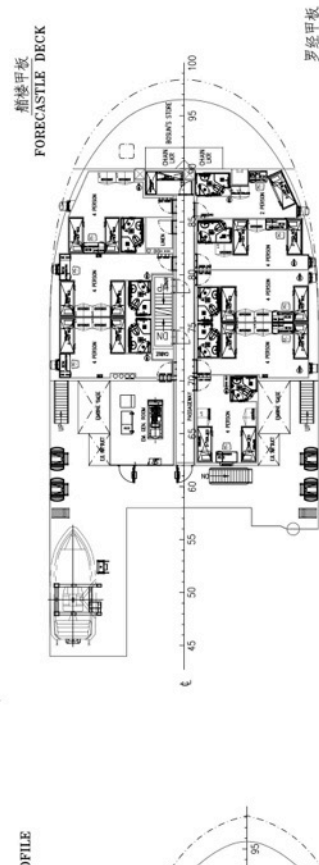
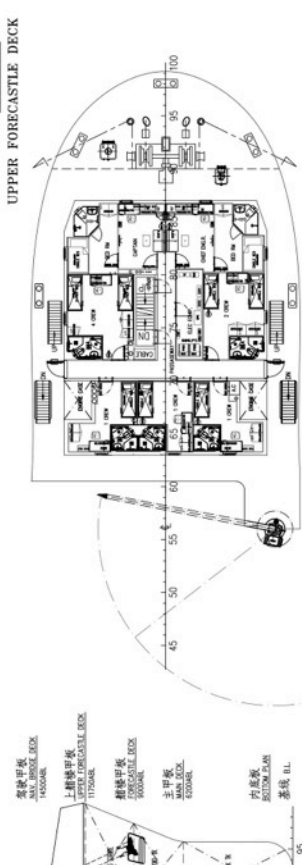
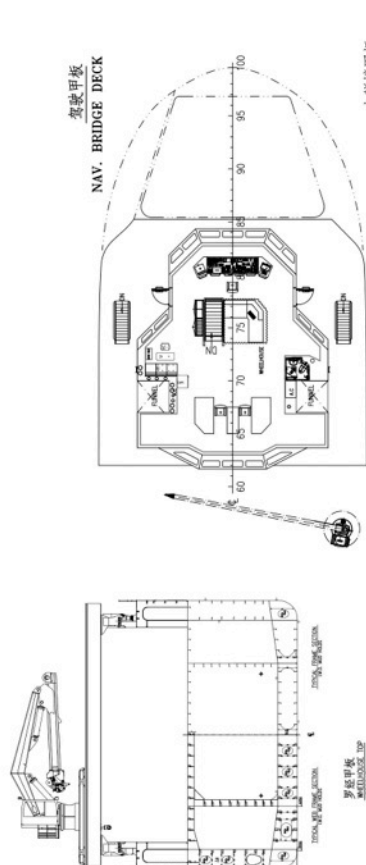

合同设计		GENERAL ARRANGEMENT
CONTRACT DRAWING		GENERAL ARRANGEMENT
图号	比例	日期
001	1:100	2021.01.15
002	1:100	2021.02.10
003	1:100	2021.03.05
004	1:100	2021.03.15
005	1:100	2021.04.05
006	1:100	2021.04.15
007	1:100	2021.05.05
008	1:100	2021.05.15
009	1:100	2021.06.05
010	1:100	2021.06.15

